

*Thank you for purchasing a Natural Light Tubular Skylight Remote Controlled Dimmer. Please call our Tech Hotline at 800.363.9865 for questions not covered in these instructions.*

## **PLEASE READ BEFORE INSTALLING**

The Natural Light Tubular Skylight Dimmer is fully assembled from the factory, but needs to be plugged into a standard electrical outlet. The dimmer installation should be completed in conjunction with **Steps 13 and 14** from the Tubular Skylight installation instructions.

**1.** The dimmer light pipe assembly is 13 1/2" tall and its height must be calculated into the overall light pipe length needed in the attic. The best positioning of the dimmer assembly is at the bottom of the light pipe going into the home (see illustration).

**NOTE:** If dimmer is installed along with the light kit, the dimmer section **must be placed above** the light kit section.

**2.** Join the dimmer assembly with the light pipe section with the crimped end down. Secure with the supplied tek screws and seal joints with foil tape.

**3.** The black control box must hang vertically to function properly. Using the screw provided, attach it through the hang hole located at the top of the box to any nearby stud. Make sure it is positioned above the attic insulation. If there is no stud nearby, nail a 2x4 vertically to the nearest beam and attach the control box (see illustration).

**4.** Plug electrical cord into outlet.

**5.** Continue with **Step 15** from the Tubular Skylight installation instructions.

## **REMOTE CONTROL DIRECTIONS:**

The Natural Light Tubular Skylight Dimmer is operated using the provided remote control. Pushing the "ON" button begins to rotate the dimmer panel and pushing the "OFF" button will stop the rotation. To achieve varying amounts of incoming light, adjust the "ON" and "OFF" buttons to move the dimmer panel until the desired amount of light enters the room (the dimmer panel will rotate 360 degrees).

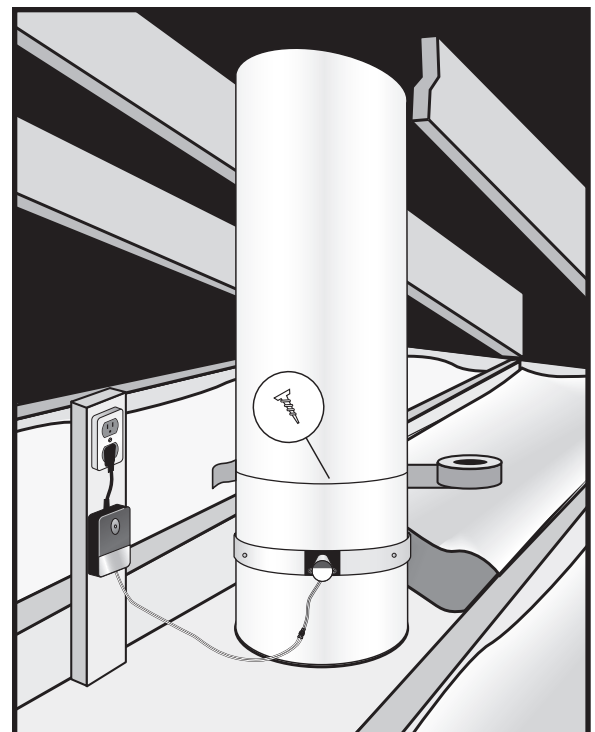
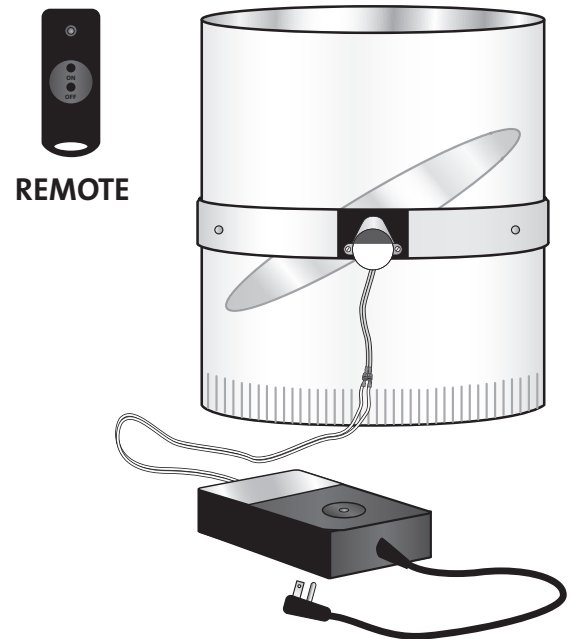



**Natural Light**

TUBULAR SKYLIGHT DIMMER

**W A R R A N T Y**

*This Natural Light Tubular Skylight Dimmer  
has a 5 year warranty.*

**IMPORTANT: PLEASE COMPLETE AND MAIL THE CARD BELOW AFTER  
YOUR DIMMER IS INSTALLED.** This card will serve as proof of your purchase, should you  
misplace your original invoice.

The manufacturer warrants this product for a period of five years  
from the date of installation. This warranty is subject to proper installation of the unit in  
accordance with the manufacturer's written installation instructions. The manufacturer will  
not be liable for any special, incidental or consequential damages in any way related to,  
or arising out of, defects in, or damage to, the tubular skylight dimmer.

This warranty gives you specific legal rights, and you may have other rights which vary from  
state to state concerning exclusion or limitation of incidental or consequential damages.

*Please fill out the form below and mail it to:*

**Natural Light Energy Systems • 10821 North 23rd Avenue • Phoenix, AZ 85029**

**R E G I S T R A T I O N**

Natural Light Dimmer Installer: \_\_\_\_\_

Customer Name: \_\_\_\_\_ Date of Purchase: \_\_\_\_\_

Address: \_\_\_\_\_

City: \_\_\_\_\_ State: \_\_\_\_\_ Zip: \_\_\_\_\_

Phone: \_\_\_\_\_ Email: \_\_\_\_\_

**Customer Survey**

Are you satisfied with the performance?    Y    N

What made you choose our product?

Were you satisfied with the installation job?