

# 21" Curb Mount / Warehouse Installation Instructions



10821 North 23rd Avenue  
Phoenix, AZ 85029  
800-363-9865  
www.nltubular.com

**IMPORTANT:** Please take the time to read through the ENTIRE instructions prior to starting any work. Light Pipe material is very sharp when cut. Please use extreme caution when handling the light pipe. AVOID LEAVING THE PIPE EXPOSED TO THE SUN WITHOUT THE PROTECTIVE COATING OR DIFFUSERS IN PLACE PRIOR TO INSTALLATION.

## PARTS LIST

- A. Clear UV Protected, High Impact Acrylic Dome
- B. (4) Phillips Head Stainless Steel ¼" Self-Tapping Screws
- C. Black Nylon Horse Hair Gasket (self-adhesive)
- D. Commercial Pure Grade, 1100 Series Aluminum Flashing
- E. (4) 1 ½" Phillips Head Stainless Steel Screws
- F. (8) 1 ½" Phillips Head Stainless Steel Screws
- G. Light Pipe, (2) 24" sections
- H. Heavy Duty Foil Tape
- I. (4) Phillips Head Stainless Steel ½" Self-Tapping Screws
- J. White Nylon Horse Hair Gasket (self-adhesive)
- K. High Impact Acrylic Prismatic Diffuser
- L. Aluminum Warehouse Trim Ring
- M. (4) Phillips Head Stainless Steel ½" Sheet Metal Screws

## TOOLS NEEDED

- Reciprocating Saw
- Phillips Screwdriver
- Marking Pencil
- Measuring Tape
- Clamp
- Tin Snips
- Driver & Bits
- Stud Finder
- Hammer

## MATERIALS/TOOLS TO BUILD CURB

- 2" x 10" Pressure Treated Lumber
- Galvanized Nails
- Hand or Circular Saw
- Roofing Material (to match existing roofing)
- Wood Screws

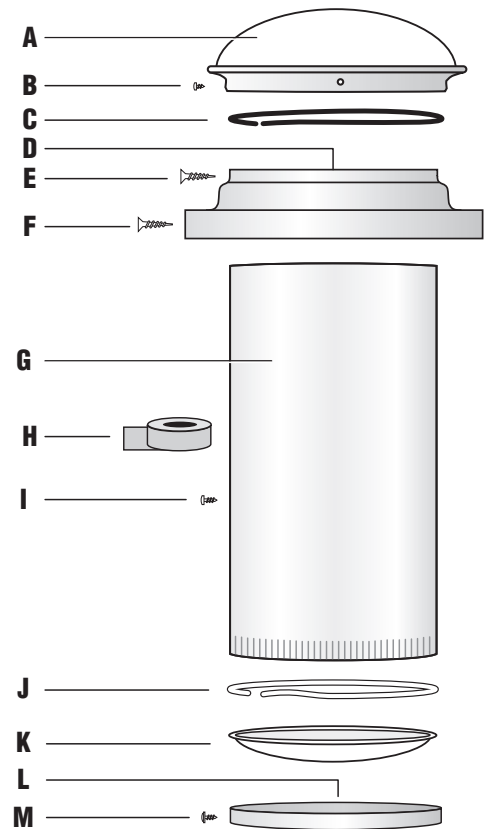

## Step 1

Assemble a curb with the **outside** dimensions slightly smaller than the width of flashing (approximately 27.5" x 27.5"). **The size of curb will vary depending on roofing material.** Use pressure-treated lumber secured at all four corners with wood screws or galvanized nails (use 2" x 10" lumber - adhere to local building codes).

**NOTE:** Do not build curb prior to being on job site.

## Step 2

From the roof, find the desired location to install the 21" unit. Ensure that there are no obstructions (wiring, framing, etc.) to hinder the installation. Mount the curb to the deck centering the curb over the space between the trusses. Using a reciprocating saw, cut out opening. **DO NOT CUT STRUCTURAL FRAMING.**

## Step 3

Place curb over opening and toe-nail into existing roofing using galvanized nails. If necessary, build blocking to ensure the curb is secure. Wrap curb with roofing material to prevent leaking.

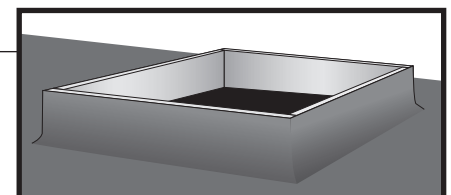
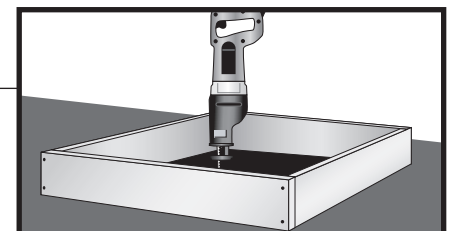
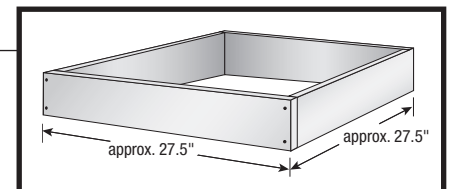

### Step 4

Attach the skylight flashing (D) to the curb using the (8) 1 1/2" Phillips head stainless steel screws (F) provided through the pre-drilled holes on the skylight flashing lip. Peel the protective backing off the black nylon horse hair gasket (C) and apply gasket to the **INNER** lip the flashing collar.

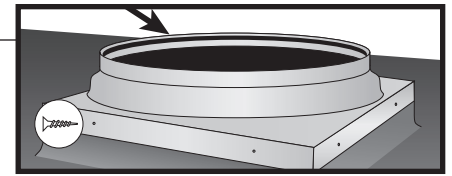

### Step 5

To assemble light pipe (G), peel back the protective coating that covers the mirror coating about 1" from the opposite edge of the double sided tape. Remove paper backing from the double-sided tape and overlap tube ends and seal edges. Put pressure on both sides of seal to ensure a good bond. Secure tube using the (2) 1/2" self-tapping screws (I) provided. Then place foil tape (H) over the entire seam to strengthen seal. When joining two pipe sections together, place crimped end into the next section of pipe. Secure with (2) 1/2" self-tapping screws (I) provided and seal joints with foil tape (H).

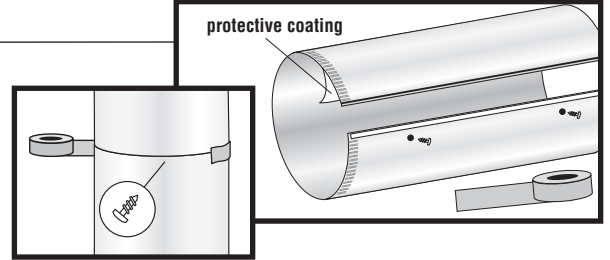

### Step 6

Place light diffuser (K) inside of the warehouse trim ring (L). Peel the protective backing off the white nylon horse hair gasket (J) and apply gasket on the **INSIDE OF THE TRIM RING** just above the diffuser. Place gasket as close to diffuser as possible.

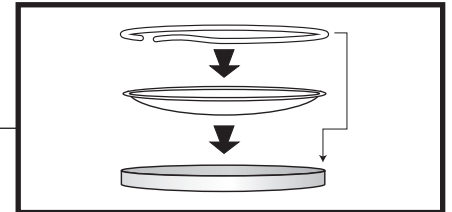

### Step 7

Slide the trim ring assembly over the crimped edge of the light pipe until it is snug. Secure the trim ring to the light pipe using the (4) 1/2" sheet metal screws (M) provided.

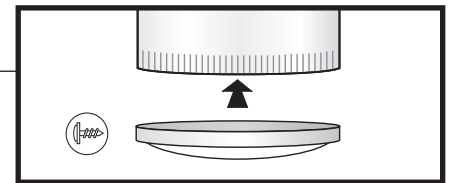

### Step 8

Slide light pipe (with trim ring facing down) through the opening on the flashing. Secure the light pipe to the flashing with the (4) Phillips flathead 1 1/2" screws (E) provided through the (4) pre-drilled holes on the flashing lip. (To prevent light pipe from slipping through the hole, clamp light pipe to flashing or have someone hold it in place until it is secured.) If there is excess pipe sticking out of the flashing, using tin snips, cut from the top down to the lip of the flashing and trim off the excess pipe.

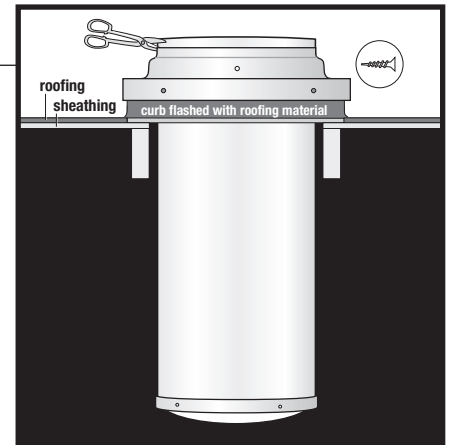

### Step 9

Place the dome (A) on top of the flashing unit. Secure the dome to flashing by screwing in the (4) self-tapping Phillips head 1/4" screws (B) provided into the pre-drilled holes in the dome collar.

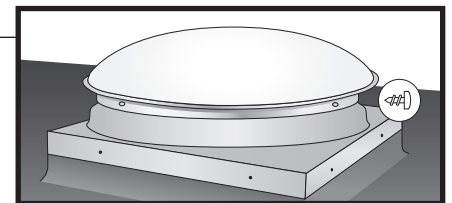

Please fill out the form and mail it to: Natural Light Energy Systems • 10821 North 23rd Avenue • Phoenix, AZ 85029

## REGISTRATION

Installer Name: \_\_\_\_\_ Date of Purchase: \_\_\_\_\_

Customer Name: \_\_\_\_\_ Phone: \_\_\_\_\_

Address: \_\_\_\_\_ City: \_\_\_\_\_ State: \_\_\_\_\_ Zip: \_\_\_\_\_

### Customer Survey

Are you satisfied with the performance? Y N      Were you satisfied with the installation job? Y N

What made you choose our product? \_\_\_\_\_